



# AEROQUIP

# INNOVATIONS

## 100R5 CRIMP FITTINGS

100R5-style crimp fittings from Eaton complement the company's industry-recognized, reusable fitting line.

Aeroquip 100R5 fittings are a low-cost, lightweight alternative for high-volume applications that do not require field-assembled fittings. Unique crimping dies are required for assembly.

100R5 crimp fittings have been designed and tested for use with FC300, 1503, FC234, FC350, and FC355 hose styles.

### Applications

- Hydraulics handling petroleum-base fluids
- Air brake
- Oil cooler
- Diesel fuel

### Features

- Designed as a one-piece fitting
- Lighter in weight than 100R5 reusable fittings
- Available in sizes -4 to -32
- Qualified with FC300, 1503, FC234, FC350, and FC355 hose styles
- DOT-approved for air brake applications

### Benefits

- One-piece design simplifies ordering and inventory
- Cost reduction compared to 100R5 reusable fittings
- Fast and easy to assemble

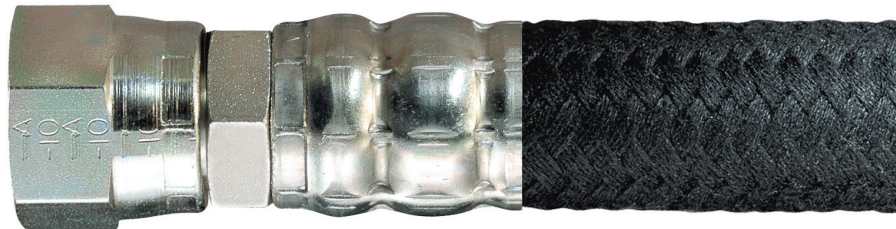

## 100R5

### CRIMP FITTINGS

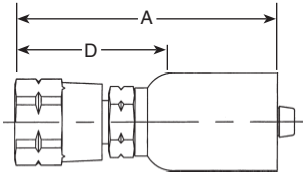

**Straight SAE 45° Swivel**

Complete Fitting Part Number	Hose Size	A (inches)	D (inches)
FJ3094-0404S	-4	1.88	1.10
FJ3094-0505S	-5	1.94	1.15
FJ3094-0606S	-6	2.07	1.28
FJ3094-0808S	-8	2.15	1.35
FJ3094-1010S	-10	2.41	1.53
FJ3094-1212S	-12	2.43	1.55

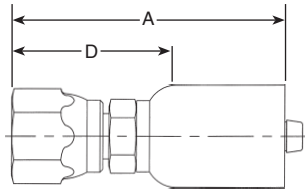

**SAE 37° (JIC) Swivel**

Complete Fitting Part Number	Hose Size	A (inches)	D (inches)
FJ3114-0404S	-4	1.88	1.10
FJ3114-0405S	-5	1.89	1.10
FJ3114-0505S	-5	1.94	1.15
FJ3114-0606S	-6	2.07	1.25
FJ3114-0608S	-8	2.12	1.32
FJ3114-0808S	-8	2.15	1.35
FJ3114-0810S	-10	2.29	1.41
FJ3114-1010S	-10	2.41	1.53
FJ3114-1212S	-12	2.43	1.55
FJ3114-1216S	-16	2.79	1.80
FJ3114-1616S	-16	2.77	1.73
FJ3114-2020S	-20	2.97	1.79
FJ3114-2424S	-24	3.43	1.94
FJ3114-3232S <sup>1</sup>	-32	4.25	2.33

<sup>1</sup>FJ3114-3232S is factory crimp only.

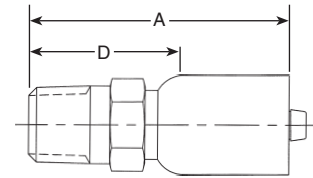

**Male Pipe**

Complete Fitting Part Number	Hose Size	A (inches)	D (inches)
FJ3152-0404S	-4	1.85	1.06
FJ3152-0406S	-6	1.85	1.06
FJ3152-0606S	-6	1.85	1.06
FJ3152-0808S	-8	2.15	1.35
FJ3152-0810S	-10	2.24	1.36
FJ3152-1212S	-12	2.24	1.36
FJ3152-1616S	-16	2.61	1.63
FJ3152-2020S	-20	2.98	1.79
FJ3152-2424S	-24	3.38	1.90
FJ3152-3232S	-32	4.11	2.19

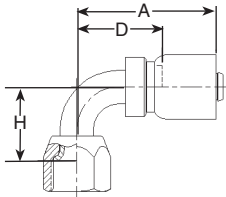

**90° Elbow (Short)**

FJ3244 – Universal Swivel  
 FJ3247 – SAE 45° Swivel  
 FJ3250 – SAE 37° (JIC) Swivel

Complete Fitting Part Number	Hose Size	A (in.)	D (in.)	H (in.)
FJ3244-0404S	-4	1.61	0.83	0.68
FJ3244-0405S	-5	1.62	0.83	0.68
FJ3244-0505S	-5	1.68	0.89	0.77
FJ3244-0808S	-8	2.07	1.27	1.09
FJ3244-0810S	-10	2.17	1.29	1.09
FJ3244-1010S	-10	2.51	1.63	1.23
FJ3247-0606S	-6	1.84	1.05	0.85
FJ3247-1212S	-12	2.78	1.90	1.82
FJ3250-0606S	-6	1.84	1.05	0.85
FJ3250-0608S	-8	1.85	1.05	0.85
FJ3250-1212S	-12	2.78	1.90	1.82
FJ3250-1216S	-16	2.94	1.95	1.82
FJ3250-1616S	-16	3.19	2.20	2.39

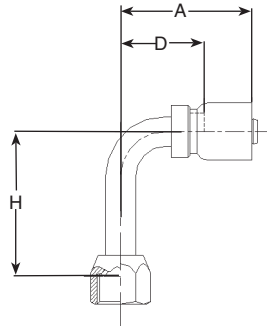

**90° Elbow (Long)**

FJ3245 – Universal Swivel  
 FJ3248 – SAE 45° Swivel  
 FJ3251 – SAE 37° (JIC) Swivel

Complete Fitting Part Number	Hose Size	A (in.)	D (in.)	H (in.)
FJ3245-0404S	-4	1.61	0.83	1.80
FJ3245-0505S	-5	1.68	0.89	1.77
FJ3245-0808S	-8	2.07	1.27	2.43
FJ3245-1010S	-10	2.51	1.63	2.57
FJ3248-0606S	-6	1.84	1.05	2.18
FJ3248-1212S	-12	2.78	1.90	3.73
FJ3251-0606S	-6	1.84	1.05	2.18
FJ3251-1212S	-12	2.78	1.90	3.73
FJ3251-1616S	-16	3.19	2.20	2.58

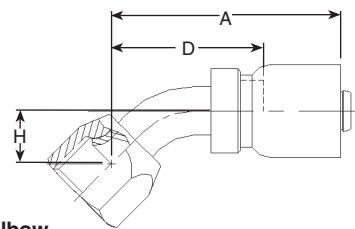

**45° Elbow**

FJ3243 – Universal Swivel  
 FJ3246 – SAE 45° Swivel  
 FJ3249 – SAE 37° (JIC) Swivel

Complete Fitting Part Number	Hose Size	A (in.)	D (in.)	H (in.)
FJ3243-0404S	-4	1.72	0.94	0.33
FJ3243-0505S	-5	1.79	0.99	0.36
FJ3243-0808S	-8	2.30	1.58	0.55
FJ3243-1010S	-10	2.50	1.62	0.63
FJ3246-0606S	-6	1.94	1.15	0.39
FJ3246-1212S	-12	2.82	1.94	0.77
FJ3249-0606S	-6	1.94	1.15	0.39
FJ3249-1212S	-12	2.82	1.94	0.77
FJ3249-1616S	-16	3.38	2.39	1.07

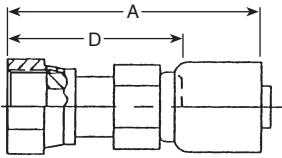

**ORS Swivel Straight**

Complete Fitting Part Number	Hose Size	A (inches)	D (inches)
FJ3468-0404S	-4	2.21	1.12
FJ3468-0606S	-6	2.45	1.21
FJ3468-0808S	-8	2.69	1.50
FJ3468-1010S	-10	3.01	1.65
FJ3468-1212S	-12	3.15	1.81
FJ3468-1616S	-16	3.50	1.94
FJ3468-2020S	-20	3.96	2.15
FJ3468-2424S	-24	4.11	2.04

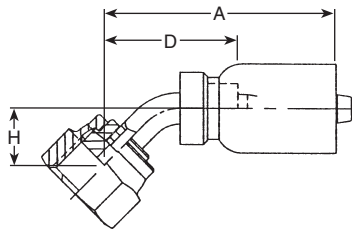

**ORS Swivel 45° Elbow**

Complete Fitting Part Number	Hose Size	A (in.)	D (in.)	H (in.)
FJ3254-0404S	-4	1.83	1.05	0.44
FJ3254-0606S	-6	1.99	1.20	0.44
FJ3254-0808S	-8	2.34	1.55	0.59
FJ3254-1616S	-16	3.25	2.27	0.95
FJ3254-2020S	-20	3.72	2.53	0.97

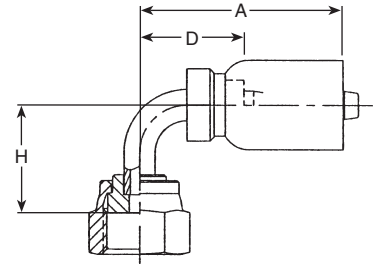

**ORS Swivel 90° Elbow (Short)**

Complete Fitting Part Number	Hose Size	A (in.)	D (in.)	H (in.)
FJ3255-0404S	-4	1.61	0.83	0.84
FJ3255-0606S	-6	1.84	1.05	0.91
FJ3255-0808S	-8	2.07	1.27	1.15
FJ3255-1010S	-10	2.30	1.42	1.31
FJ3255-1212S	-12	2.78	1.90	1.90
FJ3255-1616S	-16	3.19	2.20	2.22

## Introducing Code 61, 100R5 Flange Fittings\*

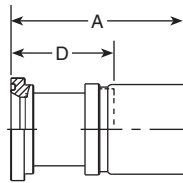

**Split Flange (Code 61)**

Complete Fitting Part Number	Hose Size	A (inches)	D (inches)
FJ3549-3232S	-32	4.75	2.83

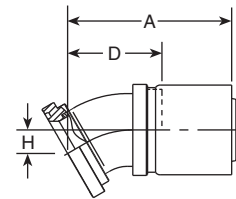

**Split Flange 30° (Code 61)**

Complete Fitting Part Number	Hose Size	A (in.)	D (in.)	H (in.)
FJ3550-3232S	-32	4.51	2.59	0.64

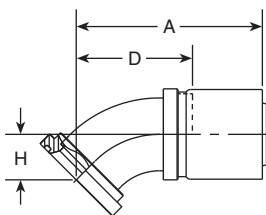

**Split Flange 45° (Code 61)**

Complete Fitting Part Number	Hose Size	A (in.)	D (in.)	H (in.)
FJ3551-3232S	-32	5.11	3.19	1.25

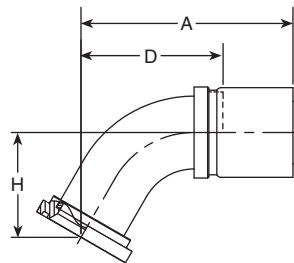

**Split Flange 60° (Code 61)**

Complete Fitting Part Number	Hose Size	A (in.)	D (in.)	H (in.)
FJ3566-3232S	-32	5.83	3.91	2.88

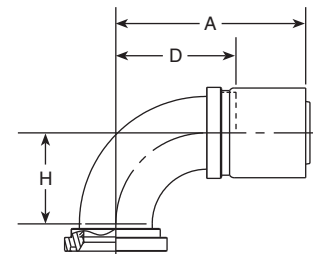

**Split Flange 90° (Code 61)**

Complete Fitting Part Number	Hose Size	A (in.)	D (in.)	H (in.)
FJ3552-3232S	-32	5.22	3.30	3.25

\*Factory crimp only — special die cages required.

## Crimp Die Part Numbers

FT1307-200-R5-\*\*  
(-04 through -32)

FT1330-275-R5-\*\*  
(-04 through -20)

FT1380-275-R5-\*\*  
(-04 through -20)

\*\*must be replaced by appropriate dash size when ordering.

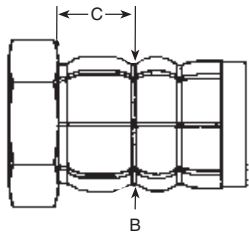

(measure crimp diameter here)

Hose/ Dash Size	Crimp Diameter "B" +/-0.15 mm	Crimp Diameter "B" +/-0.006 in	"C" Position +/-0.38 mm	"C" Position +/-0.015 in	Crimp Die Suffix	FT1340 and FT1360 Crimp Machines		
						Crimp Die	Target Setting	
<b>1503</b>								
-04	12.55	0.494	13.1	0.516	-R5-04	FT1307-200	770	
-05	13.35	0.525	13.1	0.516	-R5-05	FT1307-200	861	
-06	16.35	0.644	13.1	0.516	-R5-06	FT1307-200	729	
-08	18.35	0.722	13.1	0.516	-R5-08	FT1307-200	794	
-10	22.05	0.868	13.1	0.516	-R5-10	FT1307-200	701	
-12	25.95	1.022	13.4	0.528	-R5-12	FT1307-200	652	
-16	30.55	1.203	16.8	0.661	-R5-16	FT1307-200	792	
-20	36.35	1.431	18.4	0.724	-R5-20	FT1307-200	815	
-24	41.65	1.640	19.3	0.760	-R5-24	FT1307-200	853	
-32	55.55	2.187	25.9	1.02	-R5-32	FT1307-200	776	
<b>FC234</b>								
-05	14.05	0.553	13.1	0.516	-R5-05	FT1307-200	805	
-06	17.05	0.671	13.1	0.516	-R5-06	FT1307-200	675	
-08	19.05	0.750	13.1	0.516	-R5-08	FT1307-200	738	
-10	23.35	0.919	13.1	0.516	-R5-10	FT1307-200	598	
-12	26.25	1.034	13.4	0.528	-R5-12	FT1307-200	628	
-16	30.55	1.203	16.8	0.661	-R5-16	FT1307-200	792	
<b>FC300</b>								
-04	12.55	0.494	13.1	0.516	-R5-04	FT1307-200	770	
-05	13.55	0.533	13.1	0.516	-R5-05	FT1307-200	845	
-06	16.65	0.656	13.1	0.516	-R5-06	FT1307-200	705	
-08	18.75	0.738	13.1	0.516	-R5-08	FT1307-200	762	
-10	22.35	0.880	13.1	0.516	-R5-10	FT1307-200	677	
-12	26.15	1.030	13.4	0.528	-R5-12	FT1307-200	636	
-16	30.55	1.203	16.8	0.661	-R5-16	FT1307-200	792	
-20	36.25	1.427	18.4	0.724	-R5-20	FT1307-200	823	
-24	41.85	1.648	19.3	0.760	-R5-24	FT1307-200	837	
-32	55.05	2.167	25.9	1.02	-R5-32	FT1307-200	817	
<b>FC350</b>								
-04	12.55	0.494	13.1	0.516	-R5-04	FT1307-200	770	
-05	13.65	0.537	13.1	0.516	-R5-05	FT1307-200	837	
-06	16.35	0.644	13.1	0.516	-R5-06	FT1307-200	729	
-08	18.65	0.734	13.1	0.516	-R5-08	FT1307-200	770	
-10	22.35	0.880	13.1	0.516	-R5-10	FT1307-200	677	
-12	26.15	1.030	13.4	0.528	-R5-12	FT1307-200	636	
-16	30.55	1.203	16.8	0.661	-R5-16	FT1307-200	792	
-20	36.35	1.431	18.4	0.724	-R5-20	FT1307-200	815	
-24	42.35	1.667	19.3	0.760	-R5-24	FT1307-200	799	
<b>FC355</b>								
-04	12.55	0.494	13.1	0.516	-R5-04	FT1307-200	770	
-05	13.55	0.533	13.1	0.516	-R5-05	FT1307-200	845	
-06	16.55	0.652	13.1	0.516	-R5-06	FT1307-200	713	
-08	18.65	0.734	13.1	0.516	-R5-08	FT1307-200	770	
-10	22.35	0.880	13.1	0.516	-R5-10	FT1307-200	677	
-12	26.15	1.030	13.4	0.528	-R5-12	FT1307-200	636	
-16	30.55	1.203	16.8	0.661	-R5-16	FT1307-200	792	
-20	36.75	1.447	18.4	0.724	-R5-20	FT1307-200	782	
-24	42.25	1.663	19.3	0.760	-R5-24	FT1307-200	807	
-32	55.55	2.187	25.9	1.02	-R5-32	FT1307-200	776	

### Note

Target settings for Aeroquip crimp machines are provided to aid in establishing actual settings. While the settings on this chart will give crimp diameters close to, or at the specified value, the machine operator must check to verify the actual diameter. Before using these target settings, the crimp machine must be properly calibrated. Consult our Aeroquip equipment manual for calibration procedures.

FT1307 and FT1209 Crimp Machines		FT1390 Crimp Machine		FT1380 Crimp Machine		FT1330 Crimp Machine	
Crimp Die	Target Setting	Crimp Die	Target Setting	Crimp Die	Target Setting	Crimp Die	Target Setting
FT1307-200	0.577	FT1307-200	274	FT1380-275	89	FT1330-275	730
FT1307-200	0.737	FT1307-200	229	FT1380-275	44	FT1330-275	835
FT1307-200	0.506	FT1307-200	294	FT1380-275	109	FT1330-275	683
FT1307-200	0.619	FT1307-200	262	FT1380-275	77	FT1330-275	758
FT1307-200	0.456	FT1307-200	308	FT1380-275	123	FT1330-275	650
FT1307-200	0.371	FT1307-200	332	FT1380-275	147	FT1330-275	593
FT1307-200	0.616	FT1307-200	263	FT1380-275	78	FT1330-275	755
FT1307-200	0.655	FT1307-200	252	FT1380-275	67	FT1330-275	781
FT1307-200	0.722	FT1307-200	233	FT1380-275	48	FT1330-275	826
FT1307-200	0.587	FT1307-200	271	FT1380-275	86	FT1330-275	737
FT1307-200	0.637	FT1307-200	257	FT1380-275	72	FT1330-275	770
FT1307-200	0.410	FT1307-200	321	FT1380-275	136	FT1330-275	619
FT1307-200	0.520	FT1307-200	290	FT1380-275	105	FT1330-275	692
FT1307-200	0.275	FT1307-200	359	FT1380-275	174	FT1330-275	530
FT1307-200	0.328	FT1307-200	344	FT1380-275	159	FT1330-275	565
FT1307-200	0.616	FT1307-200	263	FT1380-275	78	FT1330-275	755
FT1307-200	0.577	FT1307-200	274	FT1380-275	89	FT1330-275	730
FT1307-200	0.708	FT1307-200	237	FT1380-275	52	FT1330-275	817
FT1307-200	0.463	FT1307-200	306	FT1380-275	121	FT1330-275	654
FT1307-200	0.563	FT1307-200	278	FT1380-275	93	FT1330-275	720
FT1307-200	0.414	FT1307-200	320	FT1380-275	135	FT1330-275	622
FT1307-200	0.343	FT1307-200	340	FT1380-275	155	FT1330-275	575
FT1307-200	0.616	FT1307-200	263	FT1380-275	78	FT1330-275	755
FT1307-200	0.669	FT1307-200	248	FT1380-275	63	FT1330-275	791
FT1307-200	0.694	FT1307-200	241	FT1380-275	56	FT1330-275	807
FT1307-200	0.658	FT1307-200	251	FT1380-275	66	FT1330-275	784
FT1307-200	0.577	FT1307-200	274	FT1380-275	89	FT1330-275	730
FT1307-200	0.694	FT1307-200	241	FT1380-275	56	FT1330-275	807
FT1307-200	0.506	FT1307-200	294	FT1380-275	109	FT1330-275	683
FT1307-200	0.577	FT1307-200	274	FT1380-275	89	FT1330-275	730
FT1307-200	0.414	FT1307-200	320	FT1380-275	135	FT1330-275	622
FT1307-200	0.343	FT1307-200	340	FT1380-275	155	FT1330-275	575
FT1307-200	0.616	FT1307-200	263	FT1380-275	78	FT1330-275	755
FT1307-200	0.655	FT1307-200	252	FT1380-275	67	FT1330-275	781
FT1307-200	0.627	FT1307-200	260	FT1380-275	75	FT1330-275	763
FT1307-200	0.577	FT1307-200	274	FT1380-275	89	FT1330-275	730
FT1307-200	0.708	FT1307-200	237	FT1380-275	52	FT1330-275	817
FT1307-200	0.477	FT1307-200	302	FT1380-275	117	FT1330-275	664
FT1307-200	0.577	FT1307-200	274	FT1380-275	89	FT1330-275	730
FT1307-200	0.414	FT1307-200	320	FT1380-275	135	FT1330-275	622
FT1307-200	0.343	FT1307-200	340	FT1380-275	155	FT1330-275	575
FT1307-200	0.616	FT1307-200	263	FT1380-275	78	FT1330-275	755
FT1307-200	0.598	FT1307-200	268	FT1380-275	83	FT1330-275	744
FT1307-200	0.641	FT1307-200	256	FT1380-275	71	FT1330-275	772
FT1307-200	0.587	FT1307-200	271	FT1380-275	86	FT1330-275	737



**FC300**  
Single wire braid  
Exceeds SAE 100R5



Part Number	Hose I.D.	Hose O.D.	Maximum Operating Pressure	Minimum Burst Pressure	Minimum Bend Radius	Vacuum Service	Weight Per Foot
	INCHES	INCHES	PSI	PSI	INCHES	INCH/Hg	POUNDS
#							
FC300-04	.19	.52	3000	12000	3.00	28	.13
FC300-05	.25	.58	3000	12000	3.38	28	.16
FC300-06	.31	.67	2250	9000	4.00	28	.23
FC300-08	.41	.76	2000	8000	4.62	28	.26
FC300-10	.50	.93	1750	7000	5.50	28	.37
FC300-12	.63	1.08	1500	6000	6.50	28	.46
FC300-16	.88	1.27	800	3200	7.38	20†	.44
FC300-20	1.12	1.50	625	2500	9.00	20†	.52
FC300-24	1.38	1.75	500	2000	10.50	15†	.67
FC300-32‡	1.81	2.22	300	1200	13.25	11†	.94
FC300-40	2.38	2.88	300	1200	24.00	8†	1.50

**Construction:** AQP elastomer tube, polyester inner braid, single wire braid reinforcement and blue polyester braid cover.

**Application:** Hydraulics handling petroleum base fluids and air, gasoline, fuel and lubricating oils, fire resistant hydraulic fluids and other industrial fluids.

**Operating Temperature Range:** -55°F to +300°F (-49°C to +150°C). Air not to exceed +250°F (+121°C).

†Maximum negative pressure shown for -16 and larger are suitable for those which has suffered no external damage or kinking. If greater negative pressures are required for -16 and larger hoses, the use of an internal support coil is recommended.

‡ Does not comply with SAE 100R5 operating pressure of 350 psi or minimum burst of 1400 psi.



**1503**  
Single wire braid  
SAE 100R5

Part Number	Hose I.D.	Hose O.D.	Maximum Operating Pressure	Minimum Burst Pressure	Minimum Bend Radius	Vacuum Service	Weight Per Foot
	INCHES	INCHES	PSI	PSI	INCHES	INCH/Hg	POUNDS
#							
1503-4	.19	.52	3000	12000	3.00	28	.13
1503-5	.25	.58	3000	12000	3.38	28	.16
1503-6	.31	.68	2250	9000	4.00	28	.23
1503-8	.41	.77	2000	8000	4.62	28	.26
1503-10	.50	.92	1750	7000	5.50	28	.37
1503-12	.63	1.08	1500	6000	6.50	28	.46
1503-16	.88	1.23	800	3200	7.38	20†	.44
1503-20	1.12	1.50	625	2500	9.00	20†	.52
1503-24	1.38	1.75	500	2000	10.50	15†	.67
1503-32	1.81	2.23	350	1400	13.25	11†	.94
1503-40	2.38	2.88	350	1400	24.00	11†	1.43

**Construction:** Synthetic rubber tube, textile inner braid, single wire braid reinforcement and synthetic rubber impregnated textile braid cover.

**Application:** For hydraulics, air, gasoline, fuel and lubricating oils.

**Operating Temperature Range:** -40°F to +250°F (-40°C to +121°C). Air not to exceed +160° F (+71°C).

†Maximum negative pressures shown for -16 and larger are suitable only for those which has suffered no external damage or kinking. If greater negative pressures are required for -16 and larger hoses, the use of an internal support coil is recommended.



**FC350**  
Engine & air brake  
FMVSS106



Part Number	Hose I.D. INCHES	Hose O.D. INCHES	Maximum Operating Pressure PSI	Minimum Burst Pressure PSI	Minimum Bend Radius INCHES	Vacuum Service INCH/Hg	Weight Per Foot POUNDS
#	○	○	⌚	⌚	⌚	↔	⚖
FC350-04	.19	.52	2000	8000	.75	28	.12
FC350-05	.25	.58	1500	6000	1.00	28	.15
FC350-06	.31	.68	1500	6000	1.25	28	.20
FC350-08	.41	.77	1250	5000	1.75	28	.22
FC350-10	.50	.94	1250	5000	2.25	28	.32
FC350-12	.63	1.08	750	3000	2.75	20	.39
FC350-16	.88	1.23	400	1600	3.50	15	.38
FC350-20	1.12	1.50	300	1200	4.50	15	.45
FC350-24	1.38	1.75	250	1000	5.50	11	.54

**Construction:** AQP elastomer tube, polyester inner braid and a single wire braid reinforcement; black polyester textile braided cover.  
**Application:** Air, gasoline, fuel lubricating oils and coolants.  
**Operating Temperature Range:** -55°F to +300°F (-49°C to +150°C). Air not to exceed +250°F (+121°C).



**FC355**  
Engine & air brake  
FMVSS106



Part Number	Hose I.D. INCHES	Hose O.D. INCHES	Maximum Operating Pressure PSI	Minimum Burst Pressure PSI	Minimum Bend Radius INCHES	Vacuum Service INCH/Hg	Weight Per Foot POUNDS
#	○	○	⌚	⌚	⌚	↔	⚖
FC355-04	.19	.52	1500	6000	.75	28	.17
FC355-05	.25	.58	1500	6000	1.00	28	.20
FC355-06	.31	.68	1500	6000	1.25	28	.24
FC355-08	.41	.77	1250	5000	1.75	28	.29
FC355-10	.50	.94	1250	5000	2.25	28	.40
FC355-12	.63	1.08	750	3000	2.75	20	.46
FC355-16	.88	1.24	400	1600	3.50	15	.50
FC355-20	1.13	1.52	300	1250	4.50	15	.59
FC355-24	1.38	1.75	250	1000	5.50	11	.69
FC355-32	1.81	2.22	200	800	8.50	11	.93

**Construction:** AQP elastomer tube, polyester inner braid and a single wire braid reinforcement, blue AQP elastomer cover.  
**Application:** Air, gasoline, fuel, lubricating oils and coolants.  
**Operating Temperature Range:** -40°F to +300°F (-40°C to +150°C). Air not to exceed 250 psi or +250°F (+121°C).



**FC234**  
Fuel and oil  
Fire resistant USCG/MMT, NMMA/BIA



Part Number	Hose I.D. INCHES	Hose O.D. INCHES	Maximum Operating Pressure PSI	Minimum Burst Pressure PSI	Minimum Bend Radius INCHES	Vacuum Service INCH/Hg	Weight Per Foot POUNDS
#	○	○	⌚	⌚	⌚	↔	⚖
FC234-05	.25	.58	1500	6000	1.00	28	.22
FC234-06	.31	.68	1500	6000	1.25	28	.25
FC234-08	.41	.76	1250	5000	1.75	28	.30
FC234-10	.50	.94	1250	5000	2.25	28	.45
FC234-12	.63	1.08	750	3000	2.75	20	.48
FC234-16	.88	1.24	400	1600	3.50	16	.51

**Construction:** AQP elastomer tube, brass plated steel wire reinforcement, braided refractory insulation and blue AQP elastomer cover.  
**Application:** Diesel fuel, gasoline, hot lube oil and water.  
**Operating Temperature Range:** -40°F to +300°F (-40°C to +150°C).

This page is part of a complete catalog which contains technical and safety data that must be reviewed when selecting a product.



HOSE

SPECIAL APPLICATION

# Other Aeroquip Product Literature

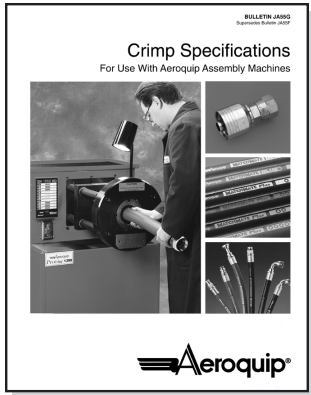

Crimp Specifications  
Bulletin JA55

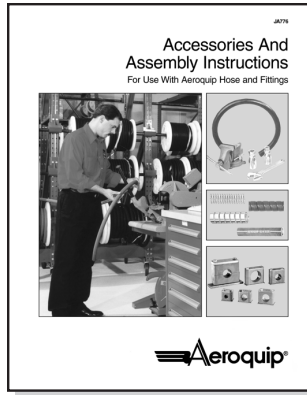

Accessories And Assembly  
Instructions Catalog JA776

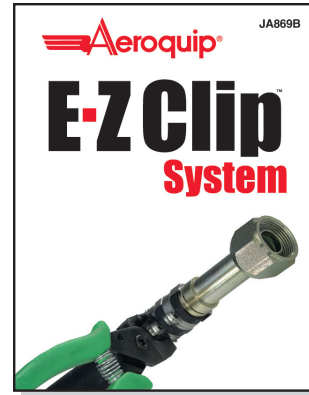

E-Z Clip Catalog  
JA869



SOCKETLESS  
Bulletin JA262



Fluid Products  
Catalog JA316

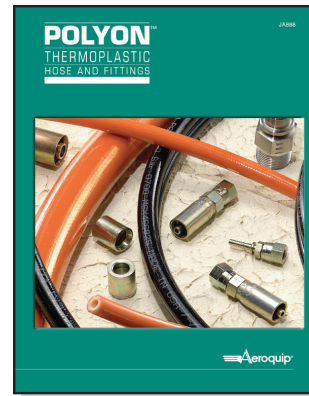

Thermoplastic  
Bulletin JA888

Eaton  
14615 Lone Oak Rd.  
Eden Prairie, MN 55344-2287  
USA  
tel: 952 937-9800  
fax: 952 974-7722  
[www.aeroquip.com](http://www.aeroquip.com)



© 2002 Eaton  
All Rights Reserved  
Printed in USA  
Document No. A-HE-MB-0001-E  
(supercedes JA897)  
May 2002